



## Single hole earth points

Hole size	Length	Weight	Part No.
M8 x 15mm	80mm	0.14kg	PC100-FU
M10 x 15mm	80mm	0.14kg	PC101
M12 x 15mm	80mm	0.14kg	PC102
M16 x 15mm	80mm	0.14kg	PC103

Stem diameter = 10.7mm (70mm<sup>2</sup>).



## Two hole earth points

Hole size	Length	Weight	Part No.
M8 x 12mm Supplied c/w front plate for connection of 25mm x 3mm copper tape or 70mm <sup>2</sup> stranded copper cable.	80mm	0.44kg	PC115-FU
M8 x 12mm Supplied c/w front plate for connection of 25mm x 3mm copper tape or 8mm diameter solid circular copper.	80mm	0.44kg	PC120
M8 x 12mm	80mm	0.28kg	PC125

Tightening torque (BS EN 50164-1:2000) 8Nm.

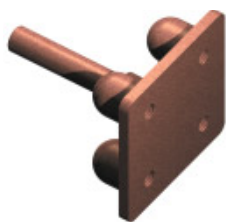

## Four hole earth points

Hole size	Length	Weight	Part No.
M8 x 14mm	75mm	0.41kg	PC110

Stem diameter = 10.7mm (70mm<sup>2</sup>).

## Earth points with pre-welded tails

Description	Weight each	Part No.
As PC100-FU with prewelded 500mm long tail of 70mm <sup>2</sup> PVC insulated earth cable	0.56kg	PC105
As PC101 with prewelded 500mm long tail of 70mm <sup>2</sup> PVC insulated earth cable	0.56kg	PC106
As PC102 with prewelded 500mm long tail of 70mm <sup>2</sup> PVC insulated earth cable	0.56kg	PC107
As PC103 with prewelded 500mm long tail of 70mm <sup>2</sup> PVC insulated earth cable	0.56kg	PC108
As PC110 with prewelded 500mm long tail of 70mm <sup>2</sup> PVC insulated earth cable	1.14kg	PC111
As PC115-FU with prewelded 500mm long tail of 70mm <sup>2</sup> PVC insulated earth cable	0.84kg	PC116
As PC120 with prewelded 500mm long tail of 70mm <sup>2</sup> PVC insulated earth cable	0.84kg	PC121
As PC125 with prewelded 500mm long tail of 70mm <sup>2</sup> PVC insulated earth cable	0.84kg	PC126-FU

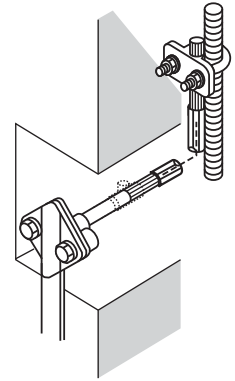
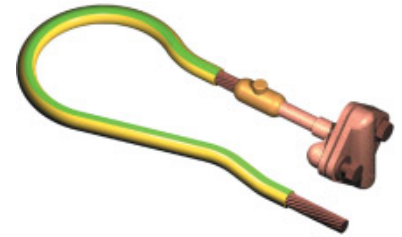

Tightening torque (BS EN 50164-1:2000) 8Nm.

## Earth boss

Length	Diameter	Thread size	Weight each	Part No.
50mm	50mm	M10	0.79kg	EB001

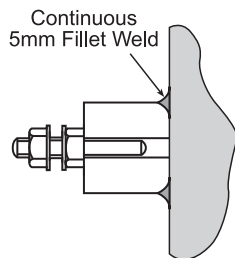

Made of mild steel to BS 970 230M07 (EN1A) with phosphor bronze stud and nuts. For welding to steel vessels/tanks/structures. Wrap connections with Denso tape.



## Insulators

Description	Thread size	Weight	Part No.
Insulator with 2 studs and 3 nuts	M10	0.22kg	IN005
Insulator only	M10	0.14kg	IN013

